

Notes:

All contractors must visit the site and be responsible for taking and checking Dimensions.

All construction information should be taken from figured dimensions only.

Any discrepancies between drawings, specifications and site conditions must be brought to the attention of the supervising officer.

This drawing and the works depicted are the copyright of JTP.

This drawing is for planning purposes only. It is not intended to be used for construction purposes. Whilst all reasonable efforts are used to ensure drawings are accurate, JTP accept no responsibility or liability for any reliance placed on, or use made of, this plan by anyone for purposes other than those stated above.

Key

Single Storey

2 Storeys

2.5 Storeys

3 Storeys

4 Storeys

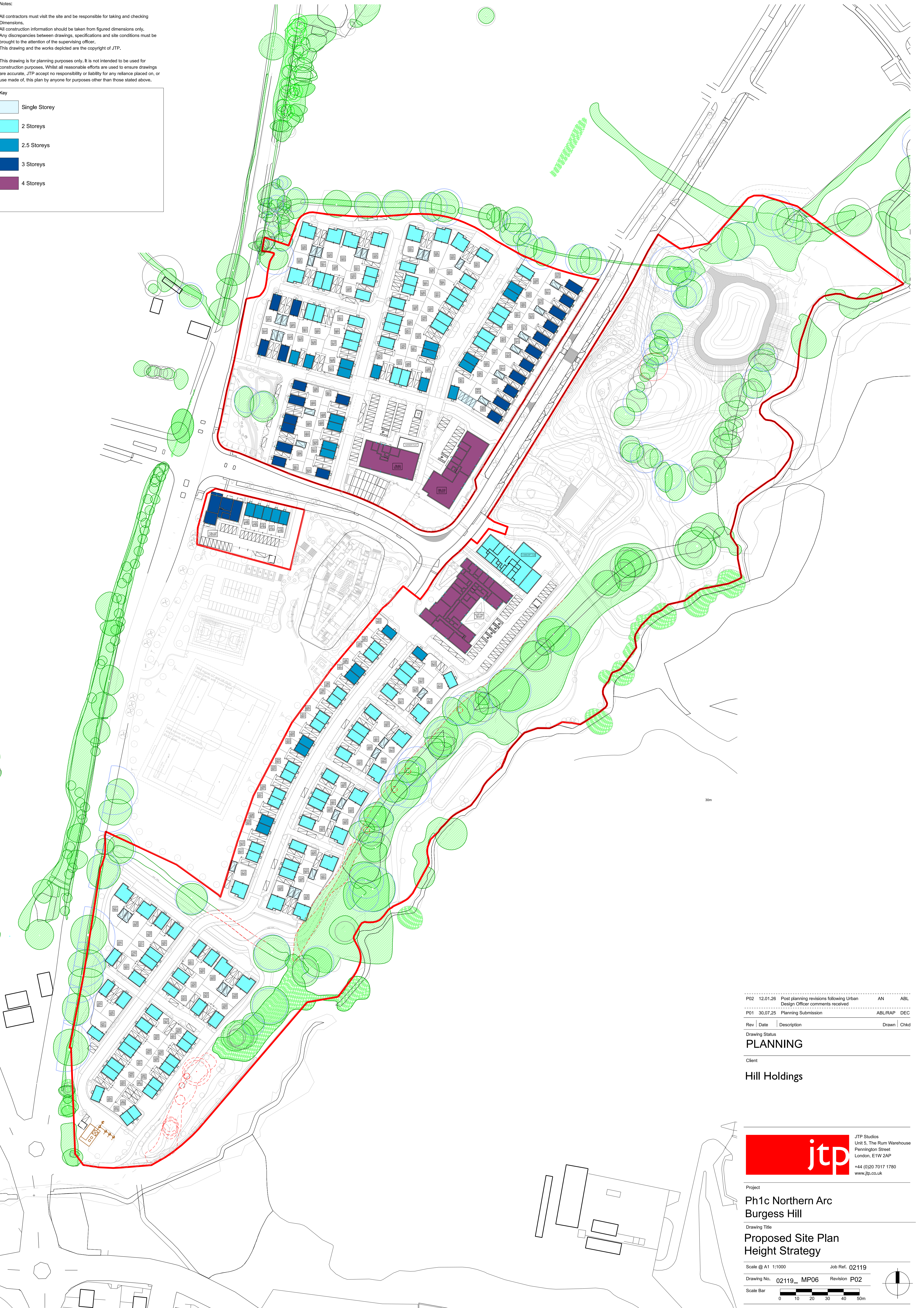

P02	12.01.26	Post planning revisions following Urban Design Officer comments received	AN	ABL
P01	30.07.25	Planning Submission	ABL/RAP	DEC
Rev	Date	Description	Drawn	Chkd

Drawing Status

PLANNING

Client

Hill Holdings

JTP Studios
Unit 5, The Rum Warehouse
Pernington Street
London, E1W 2AP
+44 (0)20 7017 1780
www.jtp.co.uk

Project

**Ph1c Northern Arc
Burgess Hill**

Drawing Title

**Proposed Site Plan
Height Strategy**

Scale @ A1 1:1000

Job Ref. 02119

Drawing No. 02119_ MP06

Revision P02

Scale Bar

