

Drawing Specific Notes:

- The timber profiles and details are shared across the proposed new timber framed double glazed windows, and are to match existing windows, with minimal frame thicknesses.
- All windows are proposed to be built of dimensionally stable Accoya acetylated softwood, or hardwood.
- The proposed first floor extension windows are shown here.

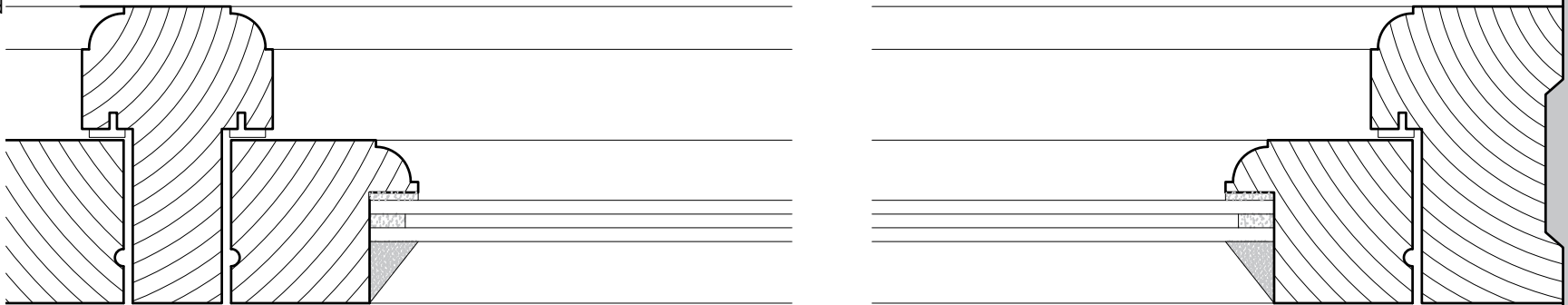
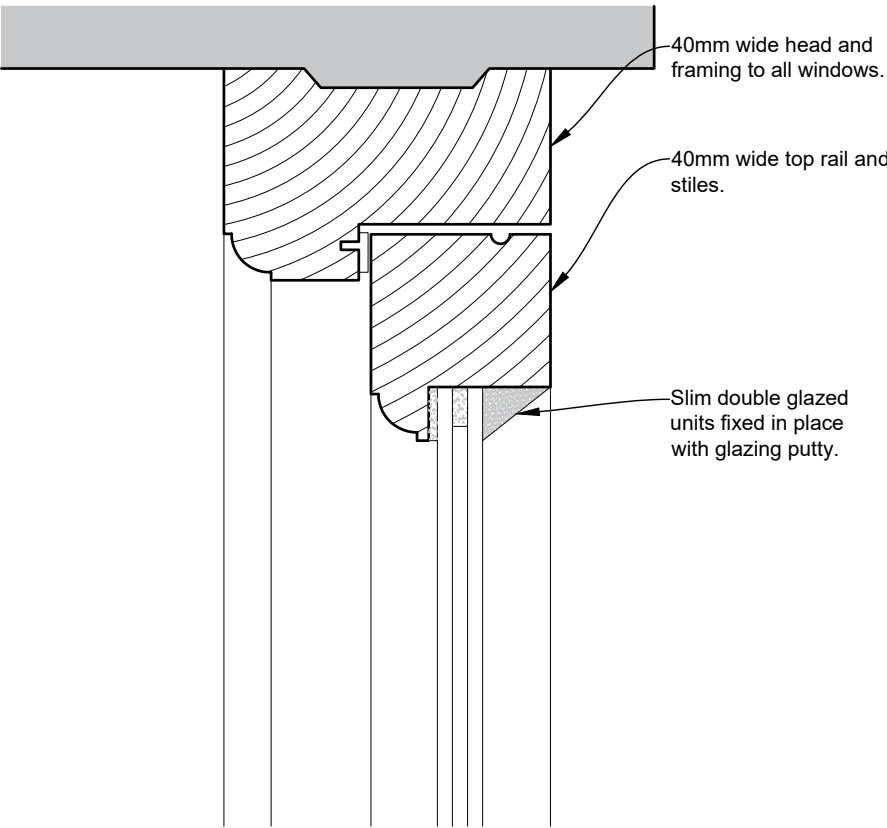

2 Window Plan
Proposed 1:2

0 0.05 0.1 0.2
Scale in metres

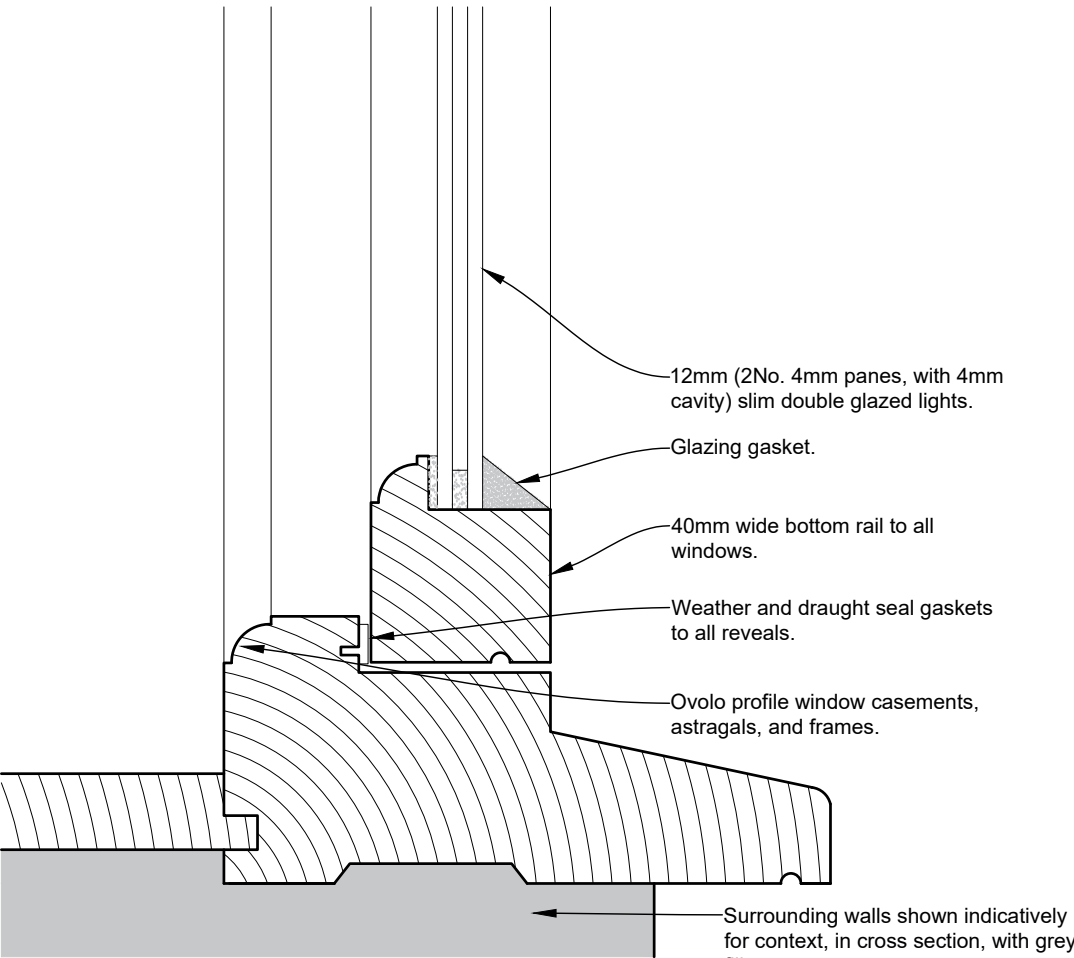

1 Window Section
Proposed 1:2

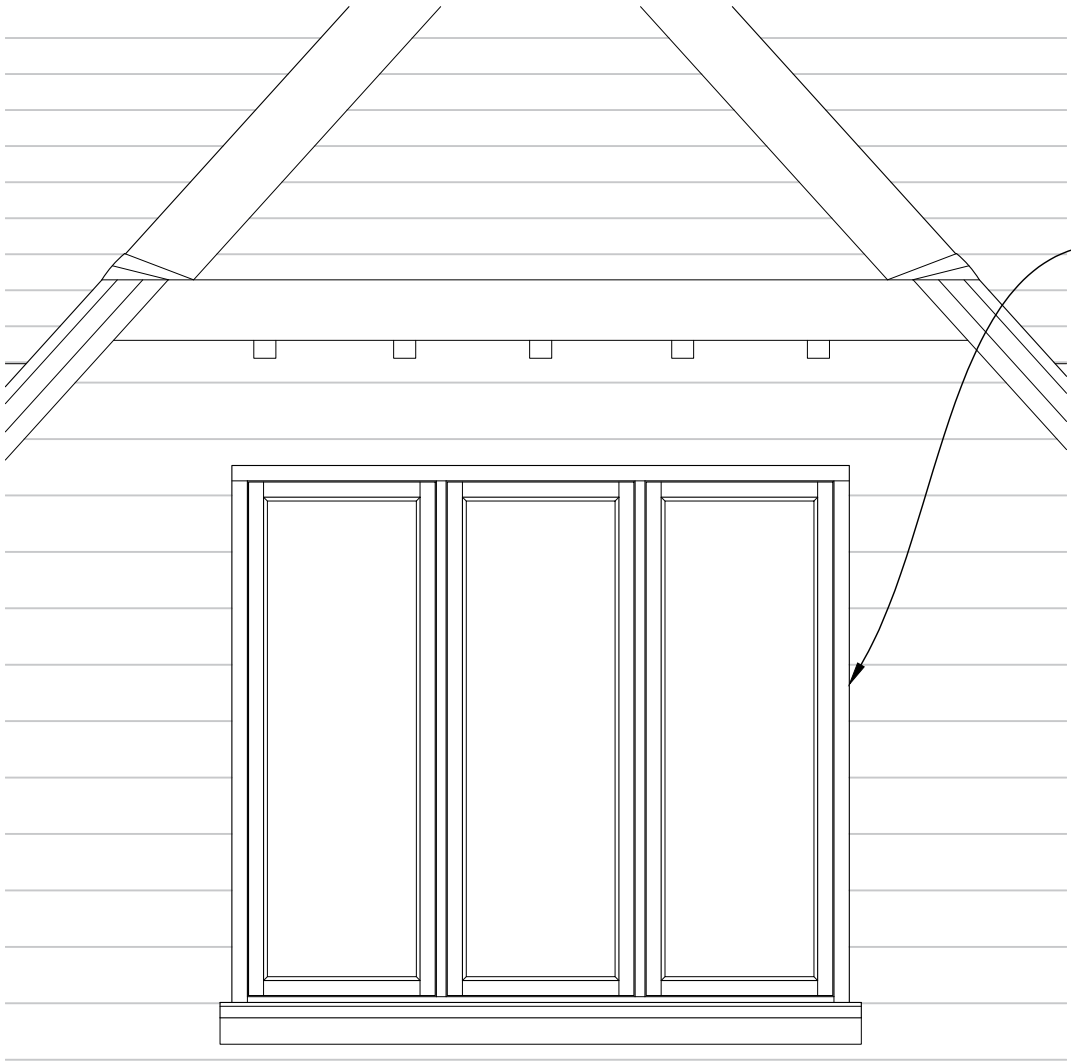

3 Window Elevation
Proposed 1:20

0 0.5 1.0 2.0
Scale in metres

14/07/2025 Planning Application Drawing Issue. JKC HEC

Rev.	Date	Notes	Drawn	Checked

CEROWSKI ARCHITECTS
East Grinstead, West Sussex
tel. 07495 980 757 jonathan@cerowski.co.uk

Client:
Cuckfield Cottage Homes Trust

Project:
The Cuckfield Cottage Homes
Church Platt, Cuckfield, RH17 5LA

Drawing:
Proposed
Casement Window Details 2

Scale	Drawn By	Checked By	Issued For
1:20/1:2@A3	JKC	HEC	Planning

Drawing No. Revision

CUCO 151 /