

SOUTHBOUND FORWARD VISIBILITY
 1:500

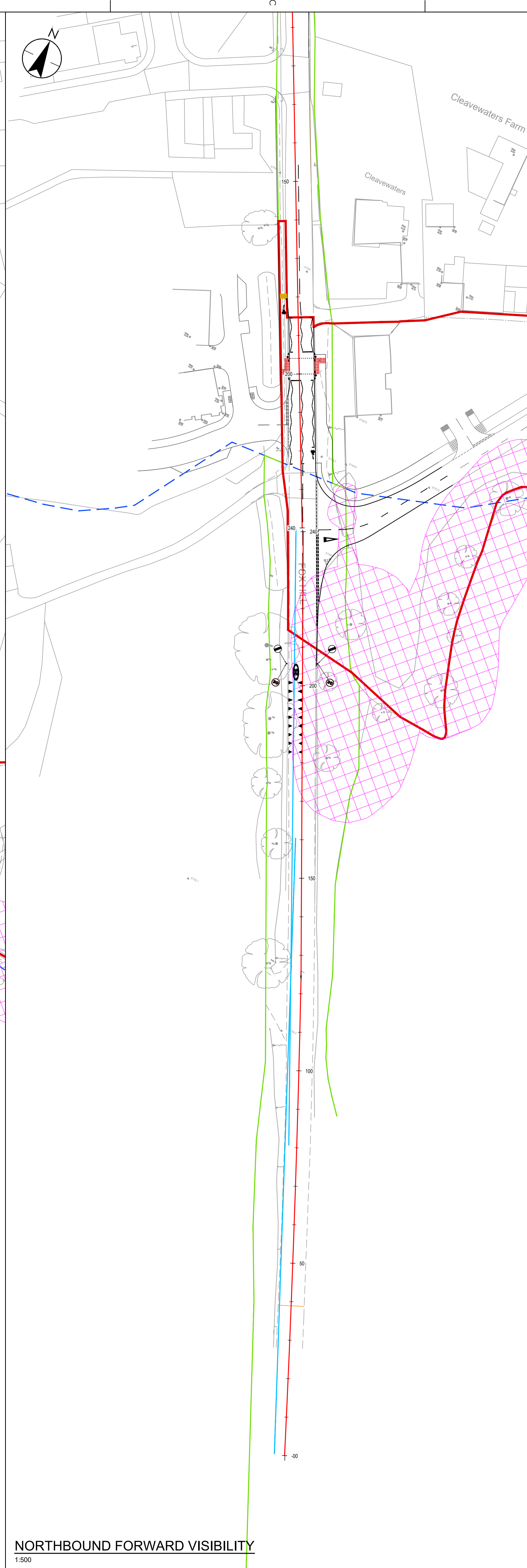

NORTHBOUND FORWARD VISIBILITY
 1:500

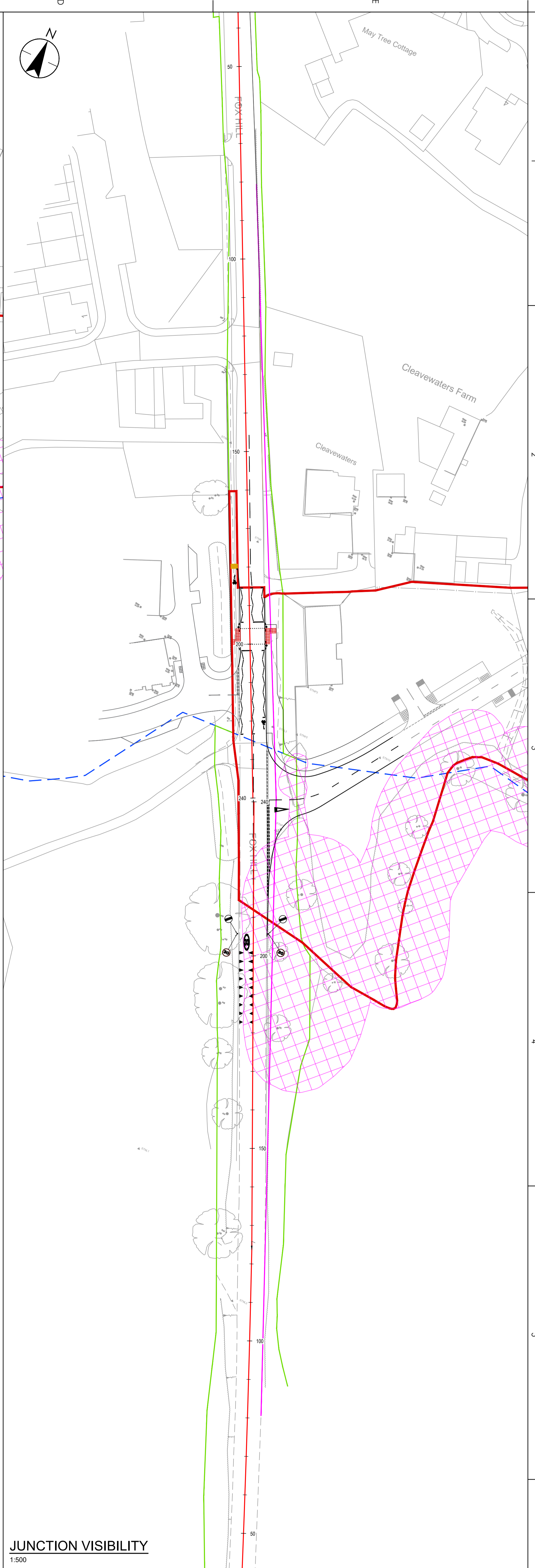

JUNCTION VISIBILITY
 1:500

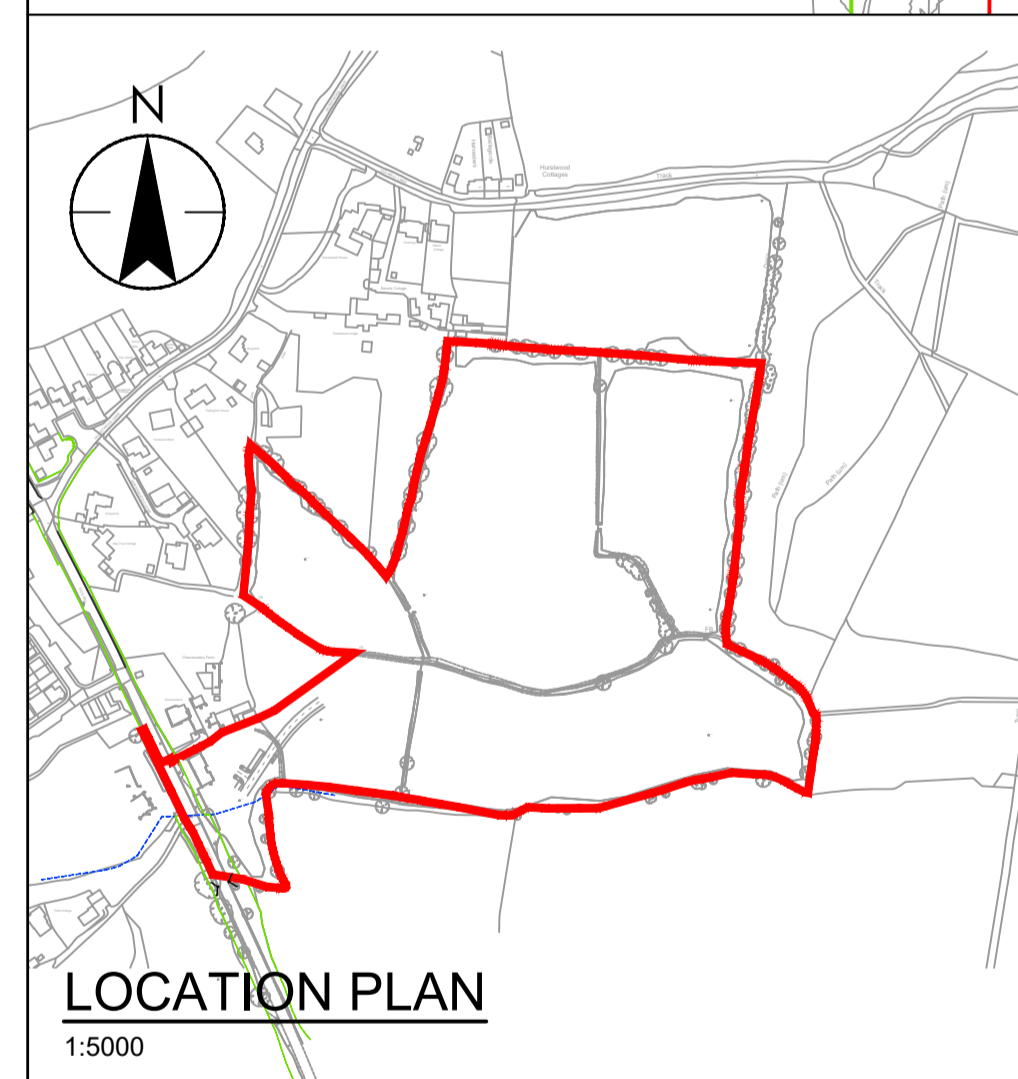

LOCATION PLAN
 1:5000

- NOTES:-**
- THIS DRAWING IS TO BE READ IN CONJUNCTION WITH CATESBY ESTATES VISION DOCUMENT.
 - IN ORDER TO MAINTAIN JUNCTION VISIBILITY, ANY AND ALL VEGETATION IN FRONT OF PLOTTED JUNCTION VISIBILITY SPLAYS IS TO BE REGULARLY CLEARED.
 - VISIBILITY SPLAYS HAVE BEEN DRAWN AS PER 85th PERCENTILE SPEEDS DERIVED FROM ATC DATA.
 - NORTHBOUND OBSERVED SPEED: 49mph
 - SOUTHBOUND OBSERVED SPEED: 39mph
 - B2112 EXISTING SPEED: 60mph
 - B2112 DESIGN SPEED: 85kph (50mph).

- KEY:-**
- PLANNING BOUNDARY
 - HIGHWAY BOUNDARY
 - EAST/WEST SUSSEX COUNTY BORDER LINE
 - PROPOSED BUFF COLOURED BLISTER TACTILE PAVING
 - PROPOSED BUFF COLOURED CORDUROY TACTILE PAVING
 - PROPOSED RED COLOURED BLISTER TACTILE PAVING
 - PROPOSED PRIMARY TRAFFIC SIGNALS (TOUCAN CROSSING)
 - PROPOSED SECONDARY SIGNAL HEADS
 - PROPOSED TRAFFIC SIGNS
 - ROOT PROTECTION ZONE AS PER EDP TREE SURVEY ISSUED TO STANTEC 08/11/24
 - 85kph FORWARD VISIBILITY SPLAYS (160m)
 - 85kph DESIRABLE MINIMUM JUNCTION VISIBILITY (x = 2.4, y = 160)

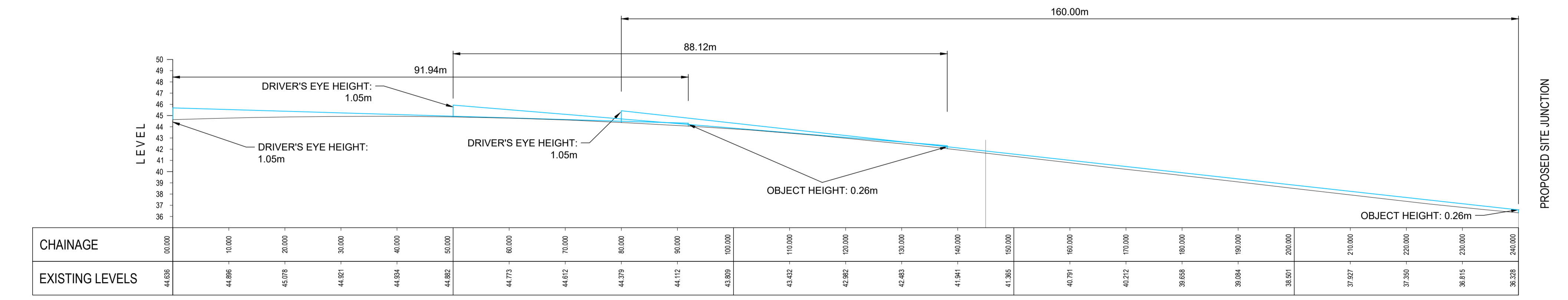
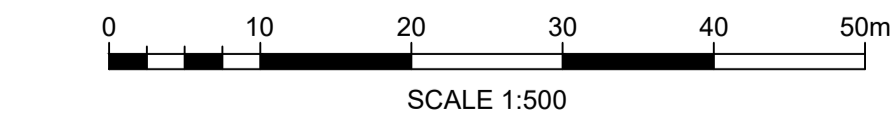

LONGITUDINAL SECTION - NORTH APPROACH FORWARD VISIBILITY - 160m (85kph / 50mph)
 SCALE H 1:500, V 1:250, DATUM 35.000mAOD

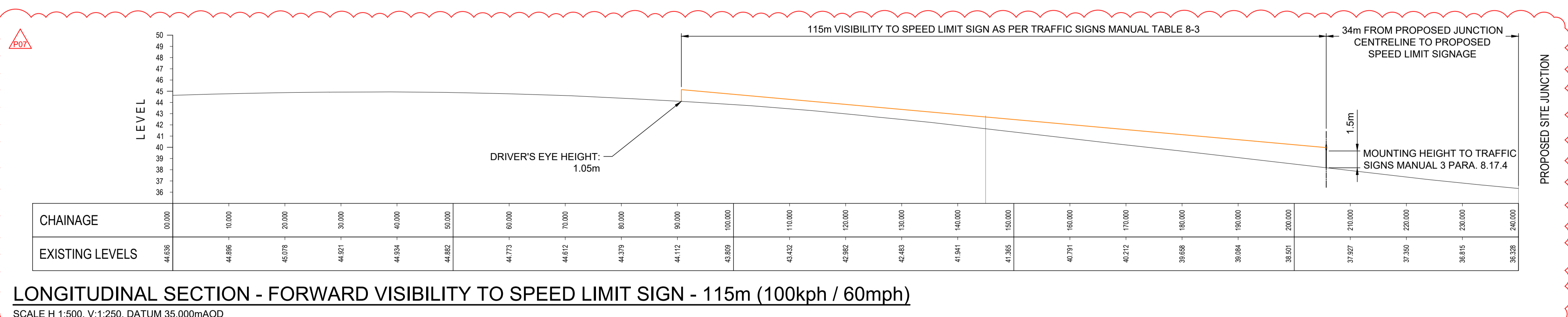

LONGITUDINAL SECTION - FORWARD VISIBILITY TO SPEED LIMIT SIGN - 115m (100kph / 60mph)
 SCALE H 1:500, V 1:250, DATUM 35.000mAOD

Client/Project:
Catesby Estates
 LAND AT LUNCE'S HILL - HAYWARDS HEATH

Project No.: 23261120
 Title: HAYWARDS HEATH SITE ACCESS VISIBILITIES
 Scale: 1:500
 Revision: 07
 Drawing No.: 3001/20/23/04/06/04/01/02

ISSUE STATUS
PLANNING

This document is suitable only for the purposes noted above. Use of this document for other purposes is not permitted.