

- Windows**
- | | | |
|------|-------------|--|
| GW01 | Living Room | Window frame in sound condition, no glazing bead |
| GW02 | Porch | Window frame in sound condition, no glazing bead |
| GW03 | WC | Poor quality replacement |
| GW04 | Kitchen | Good quality replacement |
| GW05 | Dining Room | Good quality replacement |
| GW06 | Dining Room | Good quality replacement |
| GW07 | Living Room | Window frame in sound condition, no glazing bead |
| GW08 | Dining Room | Window frame in sound condition, no glazing bead |

- Doors**
- | | | |
|------|-------------------------|---------------------------------|
| GD01 | Living Room | Original |
| GD02 | Porch | Original |
| GD03 | WC | Original |
| GD04 | Kitchen/Dining Room | Original |
| GD05 | Dining Room/Living Room | Original |
| GD06 | Dining Room | Good condition, no glazing bead |
- Radiator**
- | | |
|----------|--------------------------------------|
| Radiator | Not historic - modern panel radiator |
|----------|--------------------------------------|

- Dining Room**
- | | |
|-----------------------|---|
| Floor | Vacuum tiles |
| Wall | Lime plaster |
| Skirting board | None present |
| Door frame/architrave | Original |
| Cornice | Not historic |
| Ceiling | Lath and plaster (needing repairs in areas) |

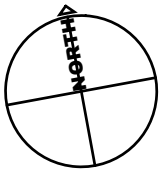

ground floor plan



notes + revisions					client + project		title		scale	number
					Telbridge Properties		Existing Ground Floor Plan		1 : 50 @ A3	2236.S06
					Twineham Court Farmhouse				date	status
					Bob Lane, Twineham				14.11.2022	SURVEY

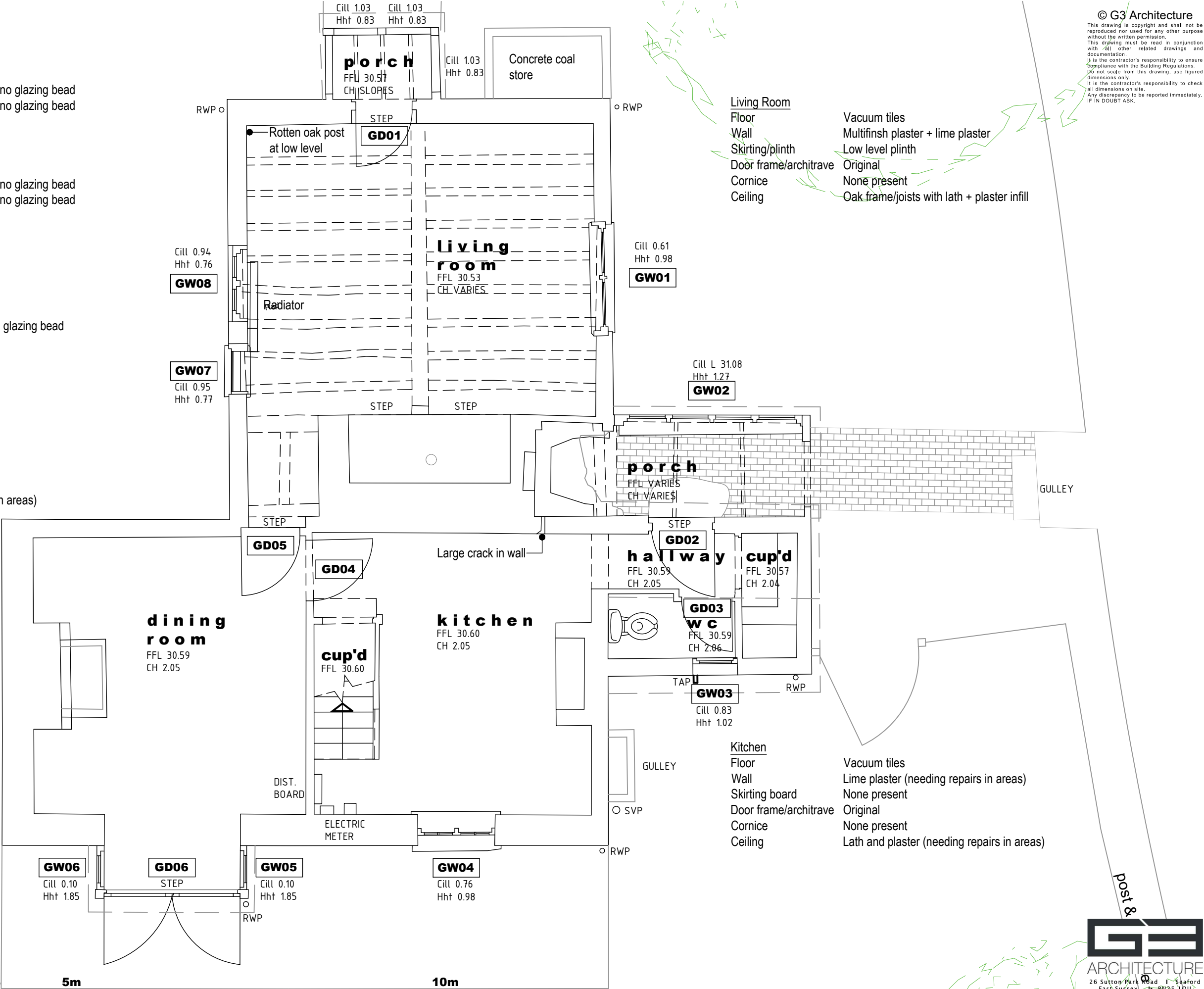

© G3 Architecture
This drawing is copyright and shall not be reproduced nor used for any other purpose without the written permission.
This drawing must be read in conjunction with all other related drawings and documentation.
It is the contractor's responsibility to ensure compliance with the Building Regulations.
Do not scale from this drawing, use figured dimensions only.
It is the contractor's responsibility to check all dimensions on site.
Any discrepancy to be reported immediately.
IF IN DOUBT ASK.

- Living Room**
- | | |
|-----------------------|---|
| Floor | Vacuum tiles |
| Wall | Multifinsh plaster + lime plaster |
| Skirting/plinth | Low level plinth |
| Door frame/architrave | Original |
| Cornice | None present |
| Ceiling | Oak frame/joists with lath + plaster infill |

- Kitchen**
- | | |
|-----------------------|---|
| Floor | Vacuum tiles |
| Wall | Lime plaster (needing repairs in areas) |
| Skirting board | None present |
| Door frame/architrave | Original |
| Cornice | None present |
| Ceiling | Lath and plaster (needing repairs in areas) |

