

Ground Floor Plan
HT13
3-Bedroom 5-Person House
93.08sqm / 1002sqft GIA (to include)

A minimum of 2.5 sqm storage provided in accordance with NDIS requirements.

Plots 34-35-36-37

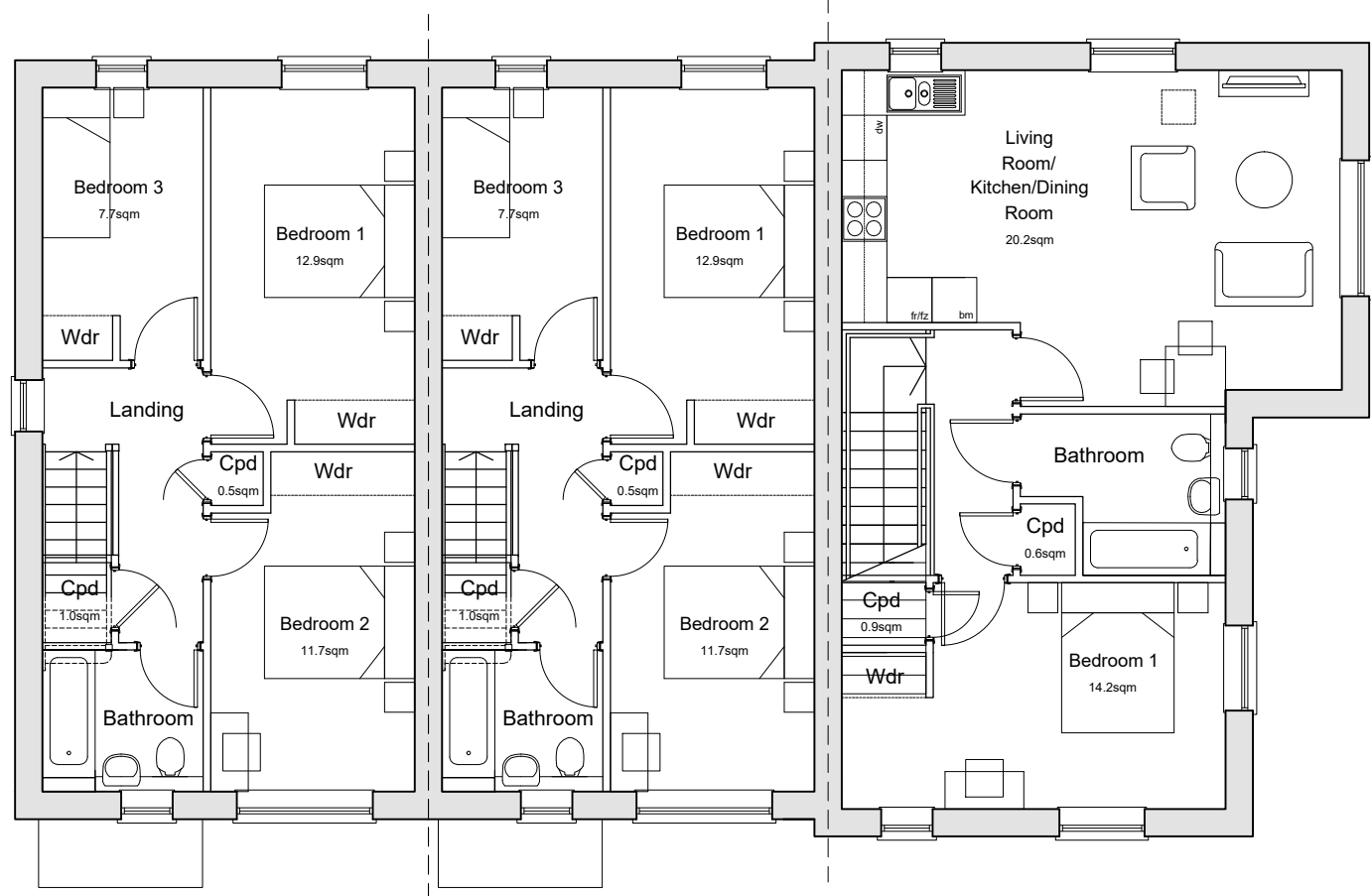

First Floor Plan

First Floor Plan
HT12
1-Bedroom 2-Person
Mainssonette
57sqm / 613sqft GIA (to include)

A minimum of 1.0 sqm storage provided in accordance with NDIS requirements.



Front Elevation



Front Elevation



Rear Elevation



Side Elevation

C	17.11.25	Updated Colour	CV	KE
B	13.11.25	Front Elevation Coloured	CV	KE
A	07.11.25	Updated Elevations	MC	KE

Rev	Date	Revision Details	Dr	Ch
-----	------	------------------	----	----

ECE Architecture

London: 76 Great Suffolk Street, London SE1 0SL, T 0207 928 2773
Sussex: 64-68 Brighton Road, Worthing, BN11 2BN, T 01903 248 777
Bristol: Beacon Tower, Colston Street, Bristol BS1 4QE, T 0117 214 1101

E: hello@ecearchitecture.com
W: ecearchitecture.com

Creatively. Quality. Commercially.
Believe what's possible.

Client's Name

Reside

Job Title

Land at Reeds Lane, Sayers Common

Drawing Title

Plans and Elevations
Plots 33-34-35-36

Scale

1:100 @ A1 / 1:200 @ A3



Drawn	Checked	Date
MC	KE	31.10.25

Job No	Drawing No	Rev
7463	PL-20	C

Status

APPROVAL