

Ground Floor Plan  
HT31  
3-Bedroom 5-Person House  
83.58sqm / 1002sqft GFA (in-house)  
A minimum of 2.5 ton storage provided in accordance with NDIS requirements.

Plots 6-7-8

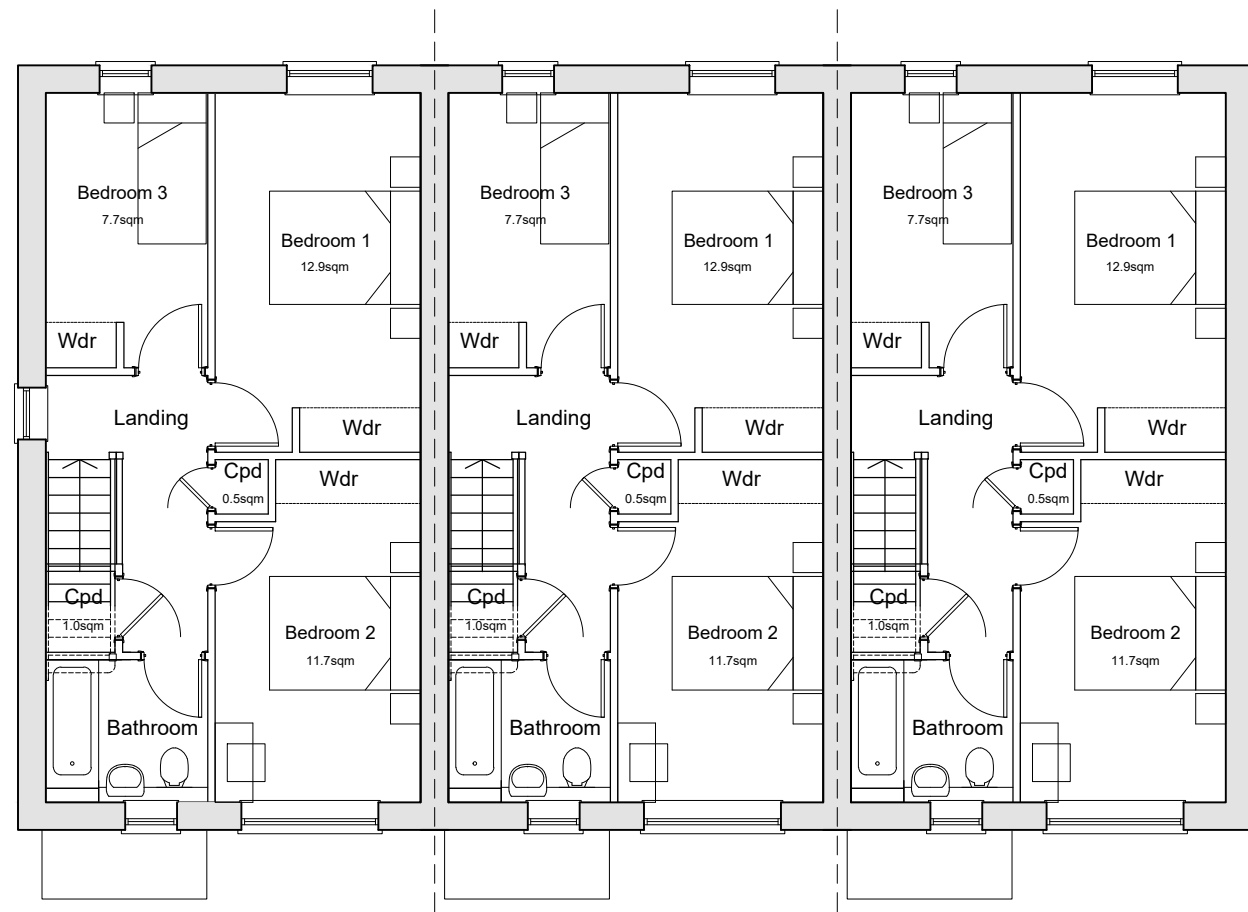

Front Elevation



Side Elevation



Rear Elevation



Side Elevation

B	13.11.25	Front Elevation Coloured	CV	KE
A	07.11.25	Updated Elevations	MC	KE
Rev	Date	Revision Details	Dr	Ch

**ECE Architecture**

London  
76 Great Suffolk Street  
London SE1 0SL  
T 0207 928 2773

Sussex  
64-68 Brighton Road  
Worthing, BN11 2BN  
T 01903 248 777

Bristol  
Beacon Tower, Colston Street  
Bristol BS1 4DE  
T 0117 214 1101

E hello@ecearchitecture.com  
W ecearchitecture.com

Creatively. Quality. Commercially.  
Believe what's possible.

Client's Name  
**Reside**

Job Title  
**Land at Reeds Lane, Sayers Common**

Drawing Title  
**Plans and Elevations  
Plots 6-7-8**

Scale  
**1:100 @ A1 / 1:200 @ A3**

Drawn  
MC

Checked  
KE

Date  
31.10.25

Job No  
7463

Drawing No  
PL-31

Rev  
B

Status  
**APPROVAL**