

Ground Floor Plan
HT31
3-Bedroom 5-Person House
93.0sqm (1000sqft GFA, 34 rooms)
A minimum of 2.5 sqm storage provided in accordance with NDIS requirements.

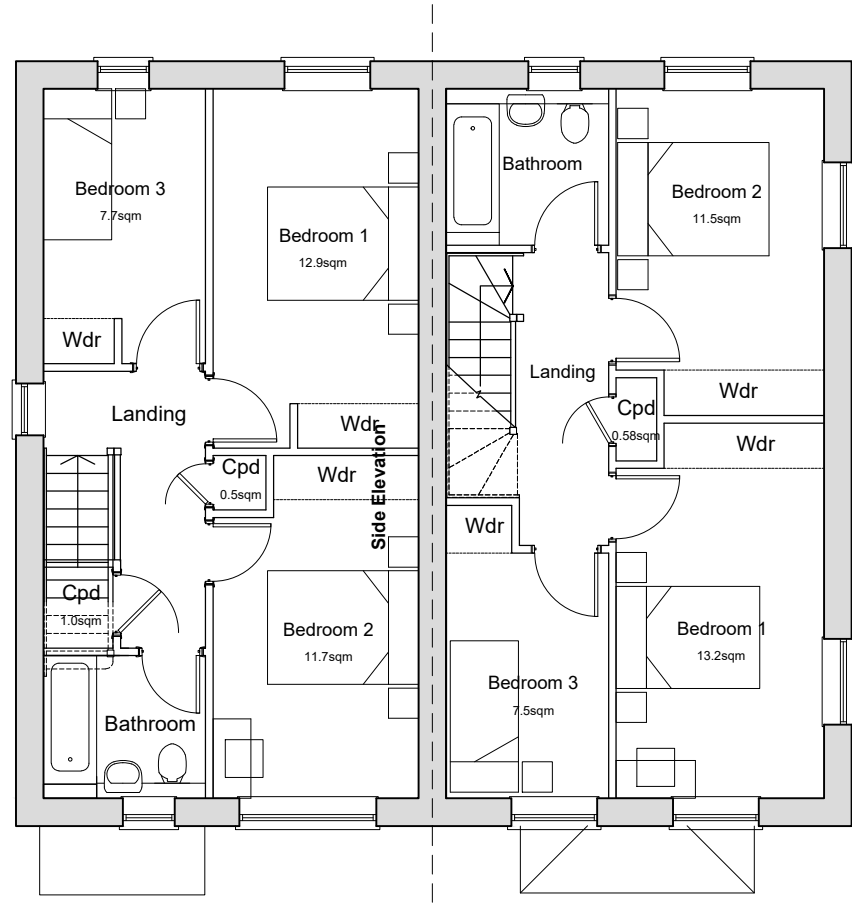

Ground Floor Plan
HT32
3-Bedroom 5-Person House
94.0sqm (1015sqft GFA, 34 rooms)
A minimum of 2.5 sqm storage provided in accordance with NDIS requirements.

Plots 16-17, 49-50, 61-62



Front Elevation



Side Elevation



Rear Elevation



Side Elevation



Front Elevation



Side Elevation



Rear Elevation



Side Elevation

C	17.11.25	Updated Colour	CV	KE
B	13.11.25	Front Elevation Coloured	CV	KE
A	07.11.25	Updated Elevations	MC	KE

Rev	Date	Revision Details	Dr	Ch
-----	------	------------------	----	----



London
76 Great Suffolk Street
London SE1 0SL
T 0207 928 2773

Sussex
64-68 Brighton Road
Worthing, BN11 2BN
T 01903 248 777

Bristol
Beacon Tower, Colston Street
Bristol BS1 4DE
T 0117 214 1101

E hello@ecearchitecture.com
W ecearchitecture.com

Creativity. Quality. Commerciality.
Believe what's possible.

Client's Name

Reside

Job Title

Land at Reeds Lane, Sayers Common

Drawing Title

Plans and Elevations
Plots 16-17, 49-50 & 61-62

Scale

1:100 @ A1 / 1:200 @ A3



Drawn	Checked	Date
MC	KE	31.10.25

Job No	Drawing No	Rev
7463	PL-32	C

Status

APPROVAL