

CLIENT	CELLS4LIFE
DRAWING	AS PROPOSED LANDSCAPING DETAILS
DATE	MAY 2025
SCALE	1:20 @ A1

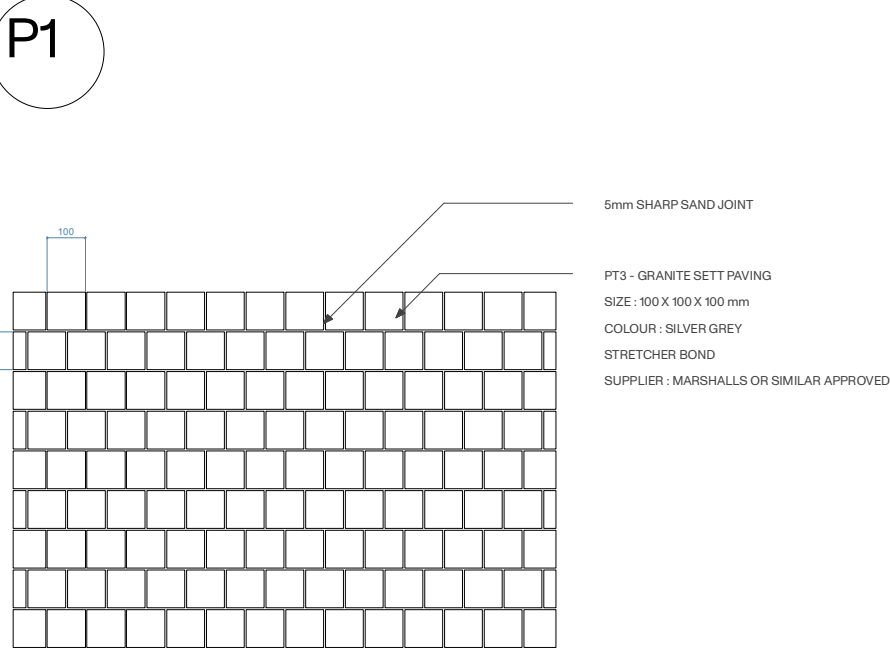

HARD LANDSCAPING TYPE 1 - GRANITE SETTS
(DETAIL PLAN)

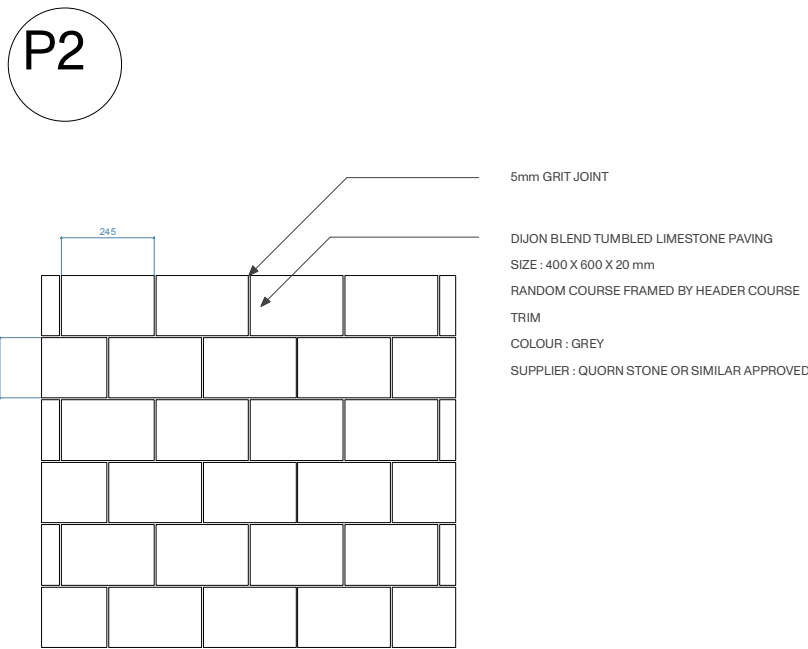

HARD LANDSCAPING TYPE 2 - NATURAL STONE PAVERS - PATIO
(DETAIL PLAN)

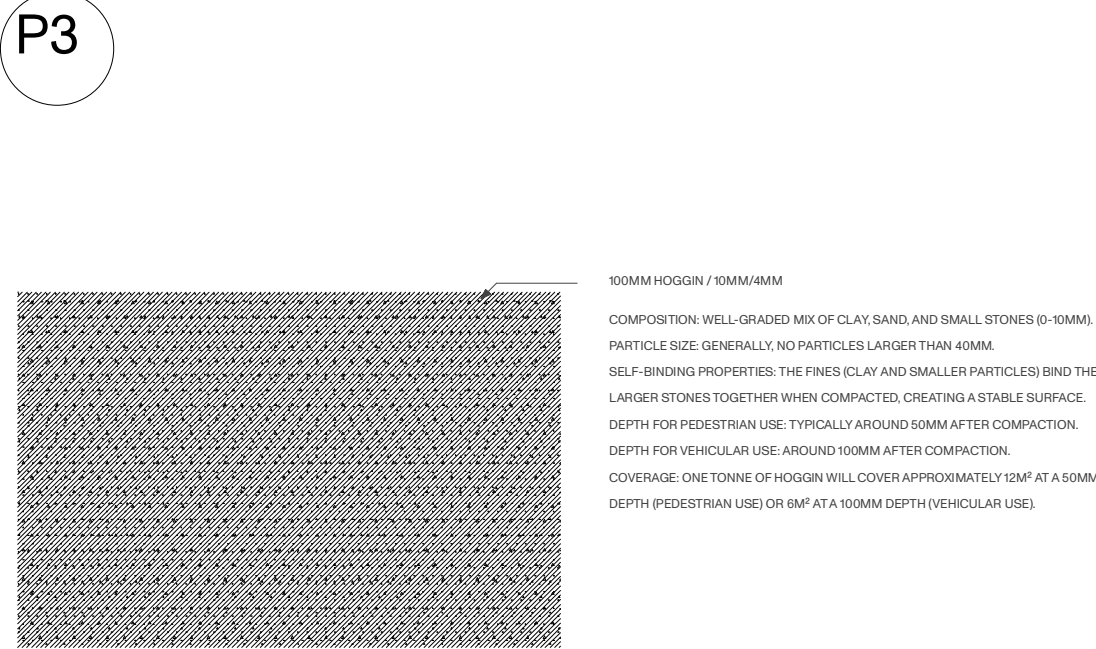

HARD LANDSCAPING TYPE 3 - 'HOGGIN' (DETAIL PLAN)

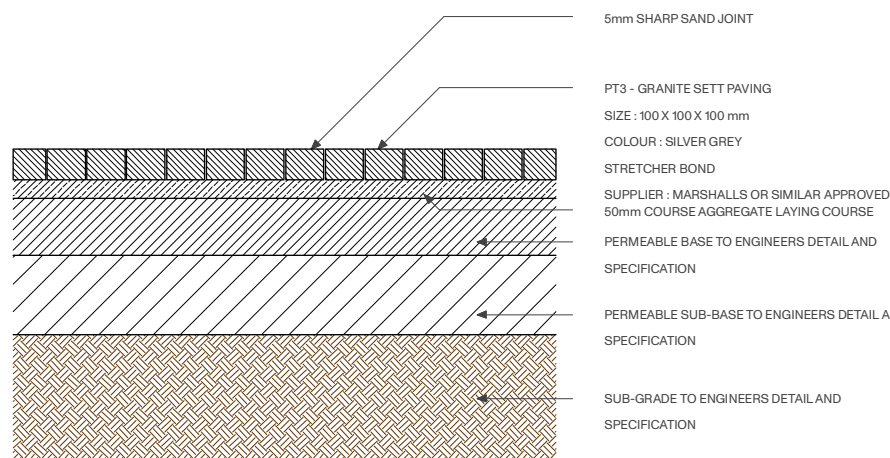

HARD LANDSCAPING TYPE 1 - GRANITE SETTS
(DETAIL SECTION)

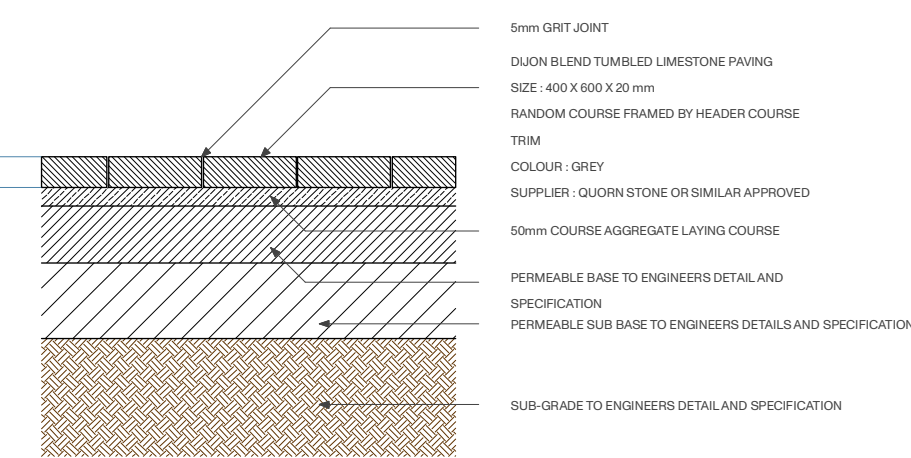

HARD LANDSCAPING TYPE 2 - NATURAL STONE PAVERS - PATIO
(DETAIL SECTION)

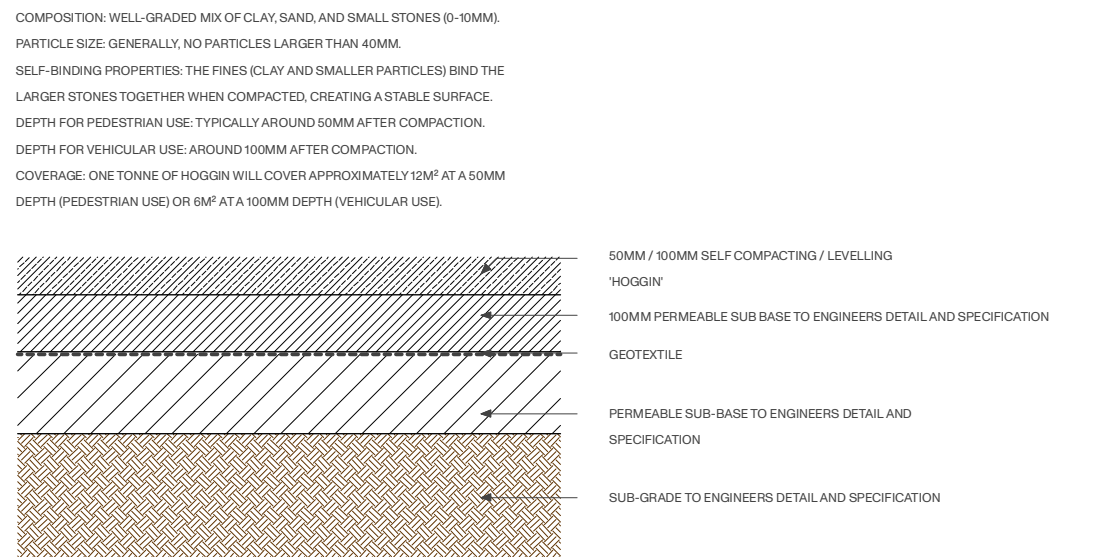

HARD LANDSCAPING TYPE 3 - 'HOGGIN' (DETAIL SECTION)

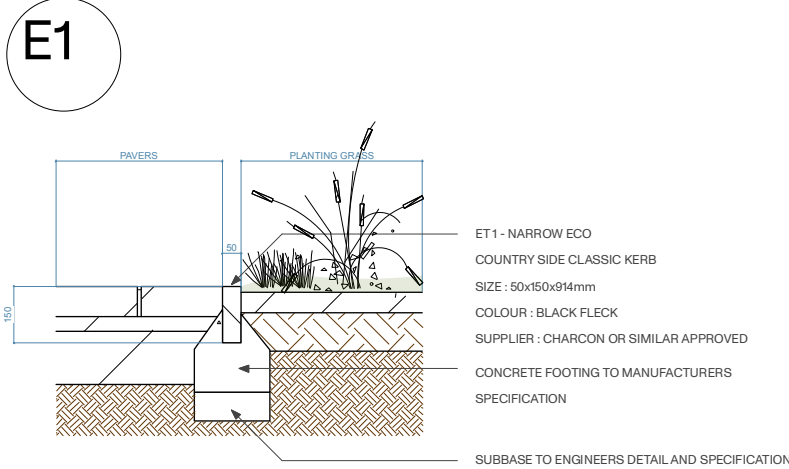

EDGE TYPE 1 - FLAT TOP EDGING (DETAIL)

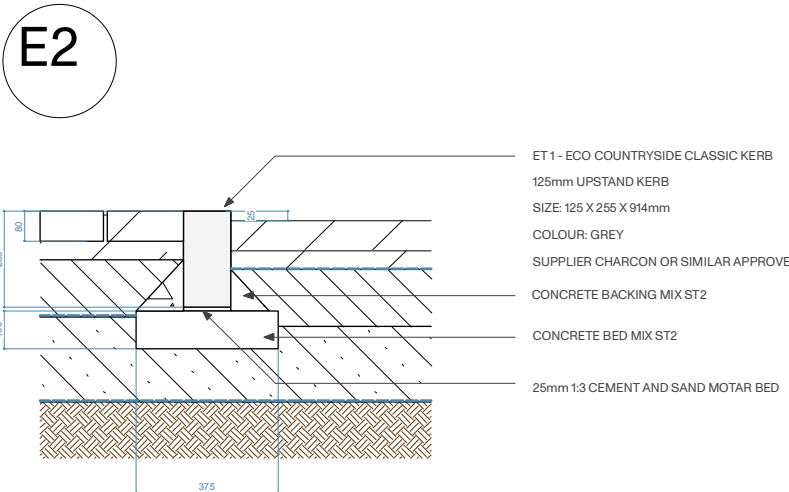

EDGE TYPE 2 - 0-25mm UPSTAND KERB - SHARED SURFACE (DETAIL)



PLANNING NOTES:

- ALL WORK TO BE CARRIED OUT TO THE SATISFACTION OF THE LANDSCAPE ARCHITECT
- NO PLANTING POSITION OR SPECIES SHALL BE ALTERED WITHOUT THE APPROVAL OF THE LANDSCAPE ARCHITECT
- PLANTING WILL COMMENCE DURING THE FIRST PLANTING SEASON (MID NOV - MID MARCH) AFTER SUBSTANTIAL COMPLETION OF THE SITE. SHOULD PLANTING COMMENCE OUTSIDE THE DORMANT PERIOD ALLOW FOR ALL BARE ROOT STOCK TO BE SUPPLIED CONTAINER GROWN
- ALL PLANT MATERIAL PROCEDURES ARE TO CONFORM TO THE RELEVANT BRITISH STANDARDS (BS38/4428) CODES OF PRACTICE. UNLESS OTHERWISE SPECIFIED PLANTING IS TO CONFORM TO NATIONAL PLANTING SPECIFICATION
- LANDSCAPE AREAS SHALL BE EXCAVATED TO THE FOLLOWING MINIMUM DEPTHS:
 - TREE PITS - 900mm
 - SHRUB AREAS - 600mm
- TYPICAL SOFT BUILD UPS: BACK FILL LANDSCAPE AREAS WITH MULTI-PURPOSE TOPSOIL TO BS 3882:2015 TO THE FOLLOWING MINIMUM DEPTHS
 - TREE PITS - 450mm (WITH MINIMUM 150mm SUBSOIL BELOW TO BS 8601:2013)
- ALL SOIL PROFILES ARE TO BE WELL KEVED IN AND SCARIFIED PRIOR TO BACKFILLING TO ENCOURAGE FREE DRAINAGE
- ALL AREAS WHERE SOIL IS TO BE INCORPORATED OVER FORMERLY HARD AREAS OR COMPACTED GROUND, THESE ARE TO BE EXCAVATED A FURTHER 300mm AND BACKFILLED TO BELOW TOPSOIL LEVEL WITH FREE DRAINING SUBSOIL TO MATCH PH OF TOPSOIL USED ON SITE. FOLLOWING SETTLEMENT OF TOPSOIL, TOP UP AREAS AND CULTIVATE TO DEPTH OF TOPSOIL
- CONTRACTORS TO ENSURE ALL PLANTING BEDS AND TREE PITS ARE FREE DRAINING
- TREES TO BE SELECTED AND PLANTED IN ACCORDANCE WITH BS 8545:2014. TREE PITS IN SOFT LANDSCAPE TO BE SQUARE AND 150mm WIDER THAN THE ROOTBALL ON ALL SIDES
- ALL SHRUBS ARE TO BE FURNISHED WITH AT LEAST 3 STRONG BREAKS AND SUPPLIED CONTAINER GROWN UNLESS OTHERWISE SPECIFIED IN BARE ROOT. SHRUBS TO BE PLANTED IN HOLES BIG ENOUGH TO ACCOMMODATE THE PLANT WITHOUT DAMAGING THE ROOTS (MIN. 300mm DEEP AND WIDE). PLANTS TO BE FIRMED, WATERED IN AND DEAD/DAMAGED BRANCHES REMOVED AFTER PLANTING
- THE USE OF PESTICIDES (HERBICIDES, INSECTICIDES, FUNGICIDES AND SLUG PELLETS ETC) SHOULD BE DISCOURAGED TO PREVENT CUMULATIVE FATAL EFFECTS TO ANIMALS VIA THE FOOD CHAIN, PARTICULARLY INVERTEBRATES, BIRDS AND/OR MAMMALS. ANY PESTICIDES USED SHOULD BE NON-RESIDUAL
- PLANT ROOTS MUST BE DIPPED IN WATER BEFORE PLANTING
- A SLOW RELEASE FERTILIZER SHALL BE APPLIED AFTER PLANTING IN ACCORDANCE WITH MANUFACTURERS INSTRUCTIONS
- GRASS SEEDS TO BE DISTRIBUTED EVENLY PERPENDICULAR SEEDING PASSES AND WATERED THOROUGHLY AFTER COCONET INSTALLATION. NEWLY SEEDER AREAS TO BE FENCED OFF TO AVOID ACCESS

T1

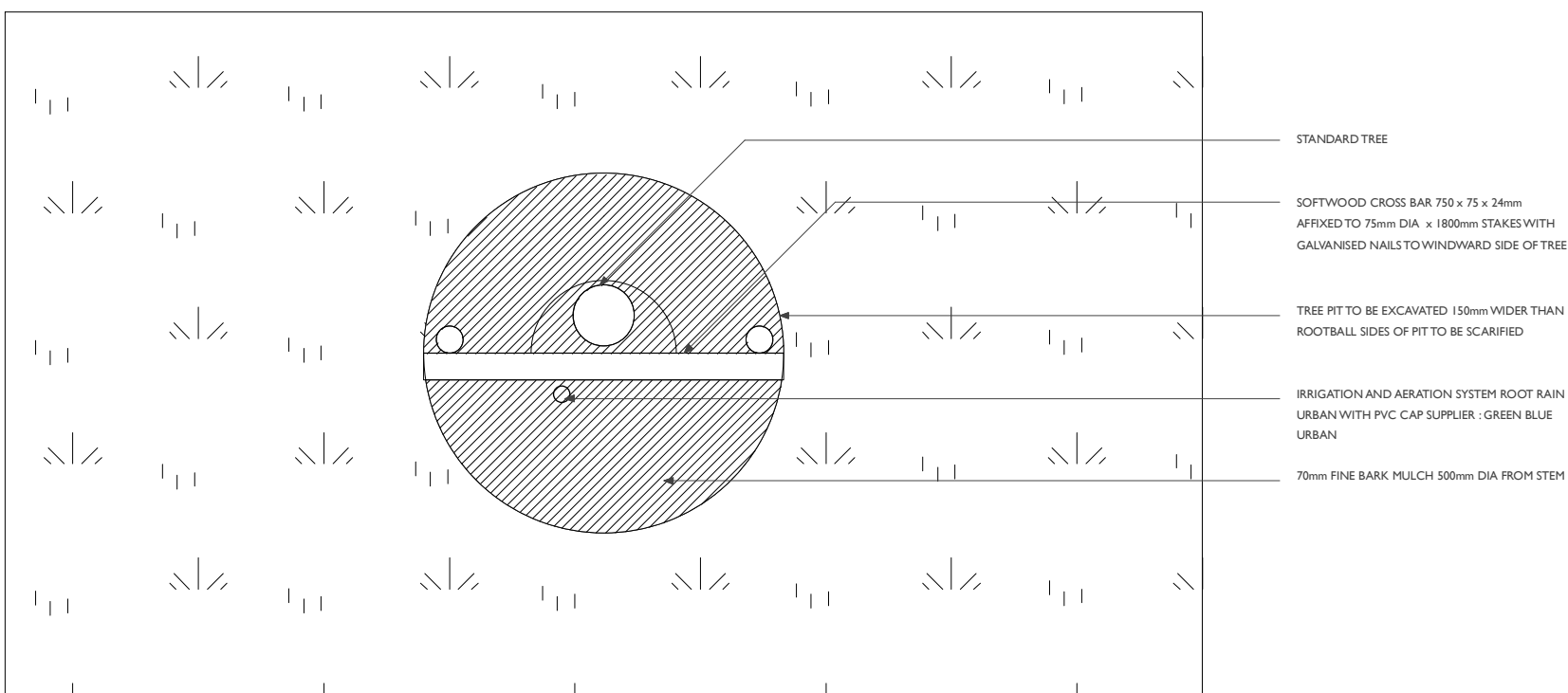

TYPICAL DETAIL, TREE PIT IN LAWN, SOFT LANDSCAPE (PLAN)

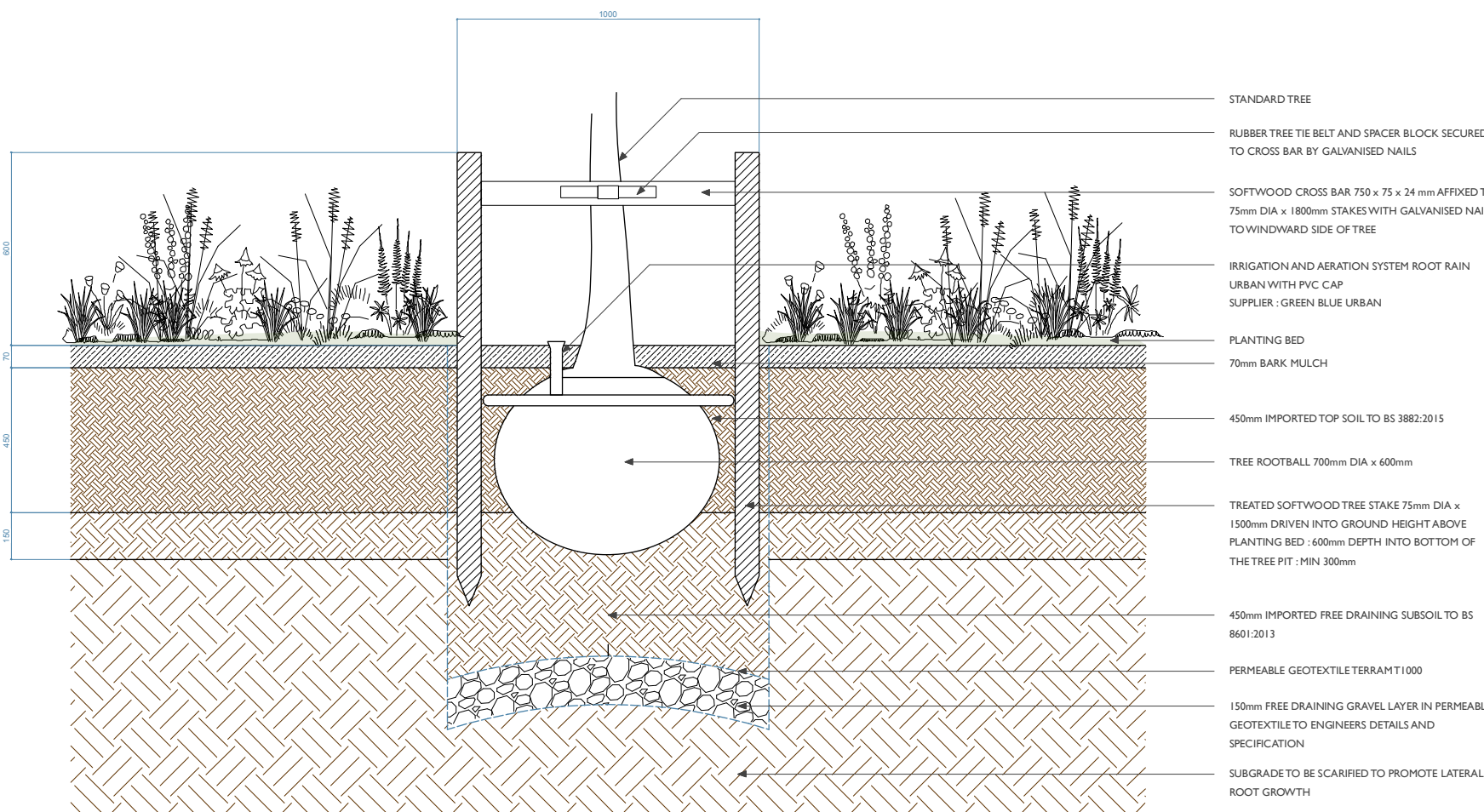

TYPICAL DETAIL, TREE PIT IN LAWN, SOFT LANDSCAPE
(SECTION)

REV	DATE	COMMENT	BY

PRINT DRAWING AT A1

N.B. Unless otherwise noted this drawing is not to be used for construction purposes. If indicated as feasibility this drawing is subject to a detailed site investigation, including ground conditions/contaminates, drainage design and planning / density negotiations. The layout may be based upon an enlargement of an os sheet or other small scale plans and its accuracy needs to be verified by survey. CDM regulations have not been fully considered.

The Workshop, unit 3,
29-42 Windsor Street,
Brighton, BN1 1RJ

landivar-architects.com
info@landivar-architects.com
01273 735690

