

PASSING PLACE A

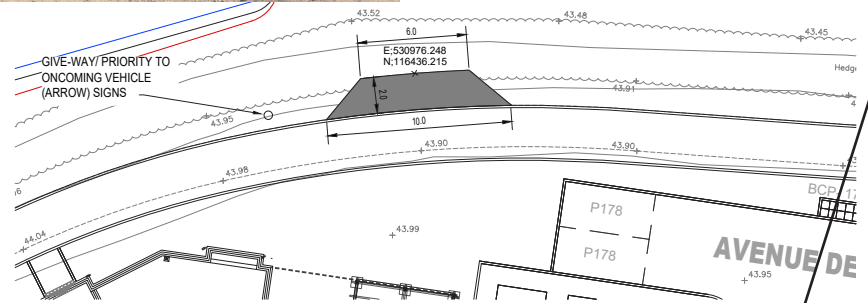

PASSING PLACE B

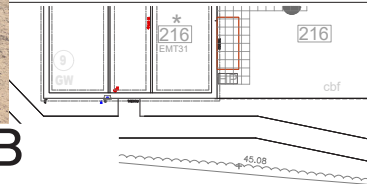

INSET 3

PASSING PLACE C

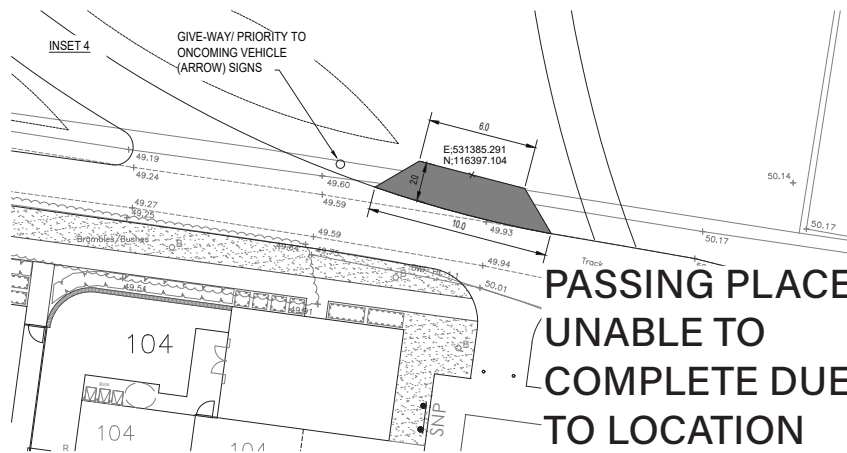
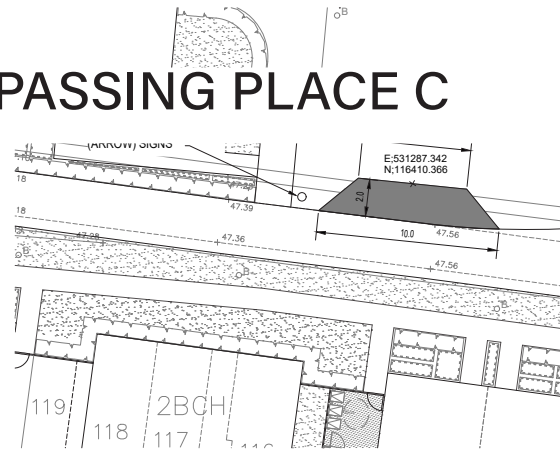

PASSING PLACE D  
UNABLE TO  
COMPLETE DUE  
TO LOCATION

**NOTES:**

1. ALL DIMENSIONS ARE TO BE TAKEN FROM THE EXISTING ROAD CENTERLINE UNLESS OTHERWISE STATED.
2. THE DRAWING IS FOR INFORMATION ONLY. IT IS NOT TO BE USED FOR CONSTRUCTION WITHOUT THE APPROVAL OF THE DESIGNER.
3. THE DRAWING IS FOR INFORMATION ONLY. IT IS NOT TO BE USED FOR CONSTRUCTION WITHOUT THE APPROVAL OF THE DESIGNER.
4. THE DRAWING IS FOR INFORMATION ONLY. IT IS NOT TO BE USED FOR CONSTRUCTION WITHOUT THE APPROVAL OF THE DESIGNER.
5. THE DRAWING IS FOR INFORMATION ONLY. IT IS NOT TO BE USED FOR CONSTRUCTION WITHOUT THE APPROVAL OF THE DESIGNER.
6. THE DRAWING IS FOR INFORMATION ONLY. IT IS NOT TO BE USED FOR CONSTRUCTION WITHOUT THE APPROVAL OF THE DESIGNER.
7. THE DRAWING IS FOR INFORMATION ONLY. IT IS NOT TO BE USED FOR CONSTRUCTION WITHOUT THE APPROVAL OF THE DESIGNER.
8. THE DRAWING IS FOR INFORMATION ONLY. IT IS NOT TO BE USED FOR CONSTRUCTION WITHOUT THE APPROVAL OF THE DESIGNER.
9. THE DRAWING IS FOR INFORMATION ONLY. IT IS NOT TO BE USED FOR CONSTRUCTION WITHOUT THE APPROVAL OF THE DESIGNER.
10. THE DRAWING IS FOR INFORMATION ONLY. IT IS NOT TO BE USED FOR CONSTRUCTION WITHOUT THE APPROVAL OF THE DESIGNER.

**LEGEND:**

GREY HATCH INDICATES PROPOSED PASSING PLACES SHOWN IN FOUR LOCATIONS

ALL ALONG PUBLIC RIGHT OF WAY 5K

EACH TO BE: 2.0m WIDE X 6.0m LONG. SEE DIMENSIONS ON PLAN.

SETTING OUT SHOWN. FINAL LOCATION TO BE CONFIRMED AGREED WITH TAYLOR WIMPEY ON SITE.

FOR CONSTRUCTION MAKEUP, SEE WHA DETAIL SHEET 1101.

ALL BAYS EDGED WITH EF KERB TO WSCC STANDARD DETAIL S278/38/02.

**WHA Ltd**  
consulting engineers

at: The Nucleus, Brunel Way, Dartford, Kent DA11 5GA  
t: 01322 310 155  
e: info@wha.co.uk  
w: www.wha.co.uk

Job Title: Woodside Grange, Hassocks, BN6 8EX  
Mr Tony Lock

**PASSING PLACES LAYOUT**

Sheet	Date	Scale	Drawn	Check	Rev
001	FEB24	1:100 & 1:500	CB	CB	1

Proj No: WHA-DR-C-SK1100

Drawn: D2

Check: P2