

Driver's Eye Height: 1.05m
Object Height: 0.26m

Vertical Profile: Scamps Hill

SCALE 1:500

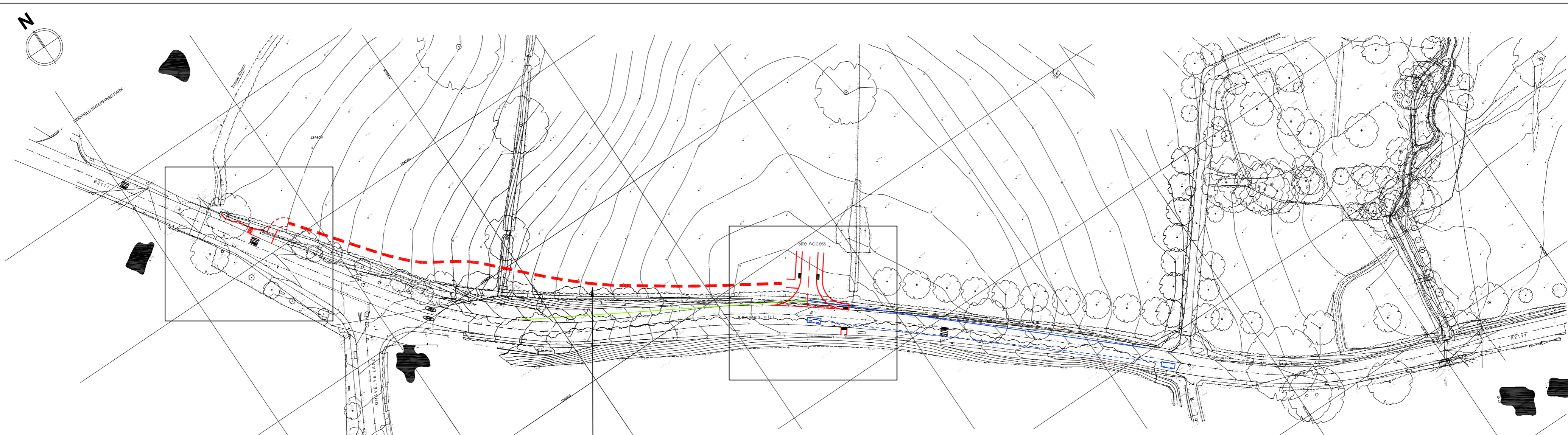
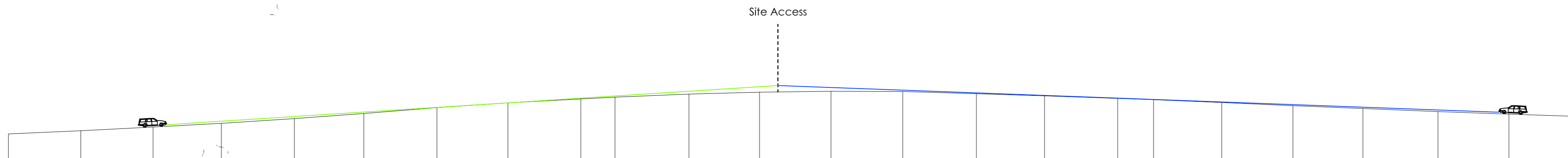

- Notes:
1. Do not scale from this drawing
 2. This drawing is copyright and may not be copied or given to a third party without written authority from Ashley Helme Associates Ltd
 3. Subject to detailed design
 4. Based upon topographical survey

- Key:
- 2.4m x 120m visibility splay
 - 2.4m x 101m visibility splay
 - - - 120m forward visibility splay
 - Proposed kerblines
 - ▴ Proposed road markings
 - ▬ Existing road markings

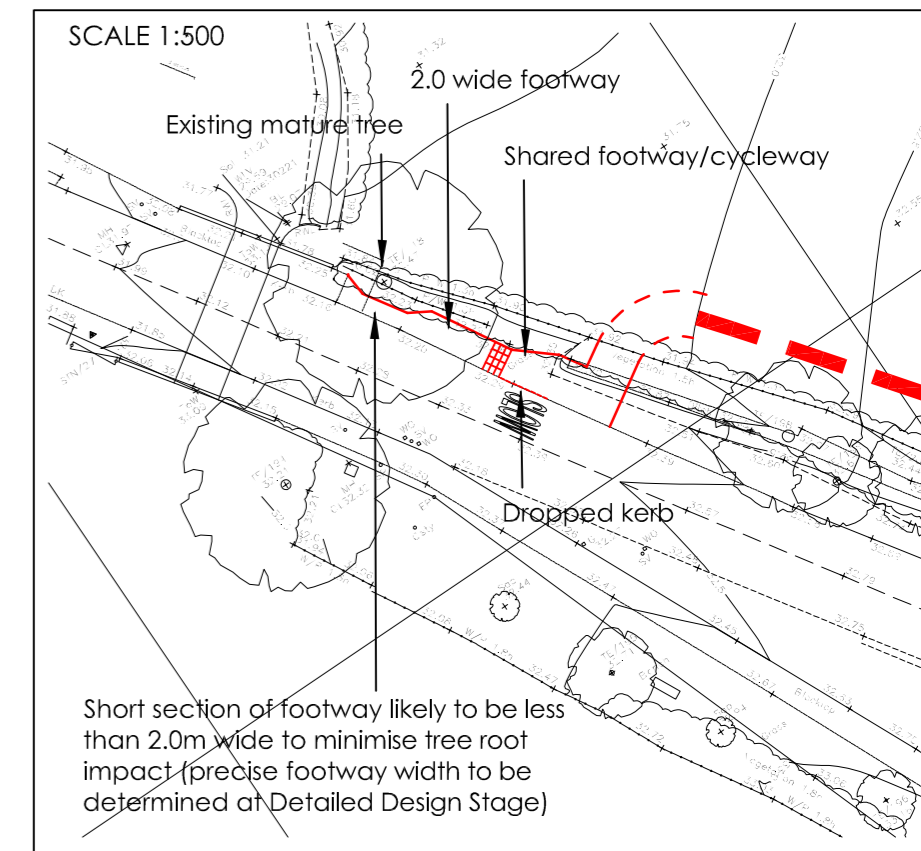
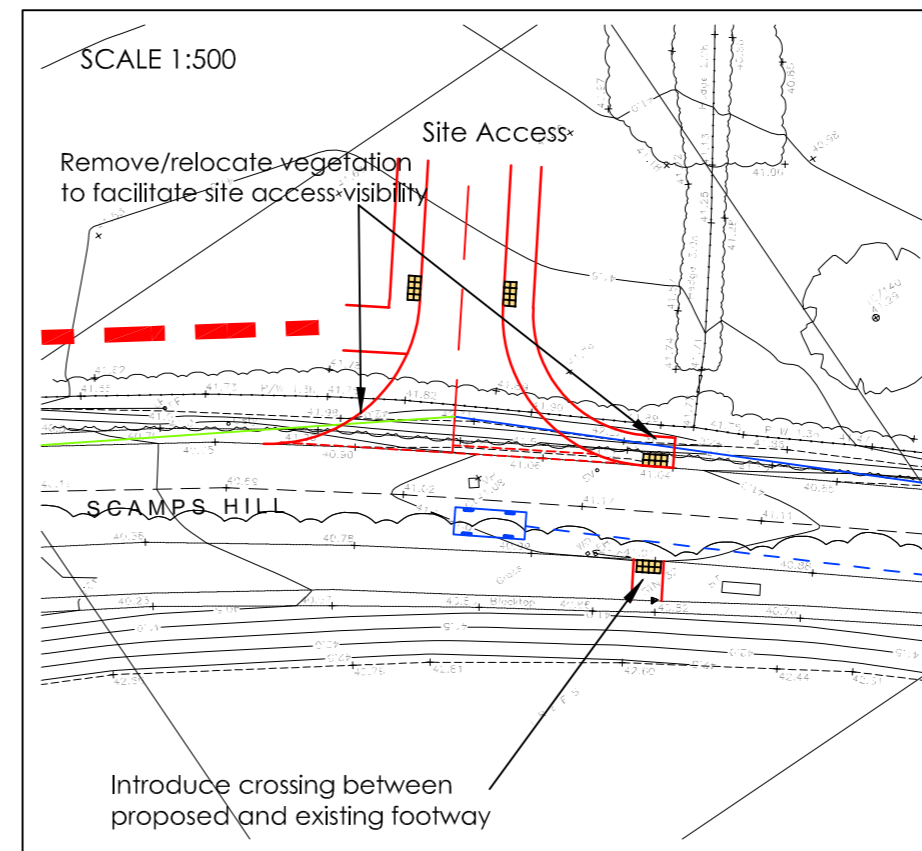

Based upon/reproduced from the Ordnance Survey Map with the Permission of The Controller of Her Majesty's Stationary Office.
© Crown Copyright Ashley Helme Associates Ltd, 76 Washway Road, Sale, Manchester, M33 7RE. Licence No AL100015126

Project	SCAMPS HILL, LINDFIELD	Title	PROPOSED ACCESS ARRANGEMENTS	Dwg No	1723/08	Rev	B		Telephone	0161 972 0552
Client	GLADMAN DEVELOPMENTS LTD	Date	MARCH 2024	Scale	1:1000@A2	Email	aha@ashleyhelme.co.uk		Website	www.ashleyhelme.co.uk
								Address	76 Washway Road, Sale, Manchester, M33 7RE	